

**§ Wide Angle *METER* § L Series**  
 AC AMMETER / VOLTMETER (MOVING IRON TYPE) **SL**

**1. AMMETER**

Normal Scale Max. scale value	Extended Scale				Approx. VA Consumption		
	2-time	3-time	4-time	5-time	SL-110C	SL-80C	SL-65C
100mA	200mA	300mA	400mA	500mA	3VA	3VA	3VA
500mA	1A	1.5A	2A	2.5A			
1A	2A	3A	4A	5A			
3A	6A	9A	12A	15A			
5A	10A	15A	20A	25A			
7.5A	15A	22.5A	30A	37.5A			
10A	20A	30A	40A	50A			
15A	30A	45A	60A	75A			
20A	40A	60A	80A	100A			
30A	60A	90A	120A	150A			
5/5A	10A	15A	20A	25A	3VA	3VA	3VA
∞	∞	∞	∞	∞			
10kA/5A	20kA	30kA	40kA	50kA			

- ▶ When the maximum scale value exceeds 30A or the circuit voltage exceeds 600V, use a 5A (0.1A, 1A) meter together with an external CT (current transformer).
- ▶ Meter for SCR waveform input (distortion waveform) can be manufactured as well. (With H at the end of type name)  
 Type name: **SL-110CH**

**CONNECTION DIAGRAM**

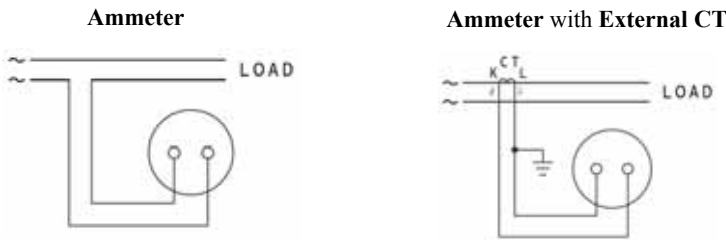

**DIMENSIONS**

**L-110C**

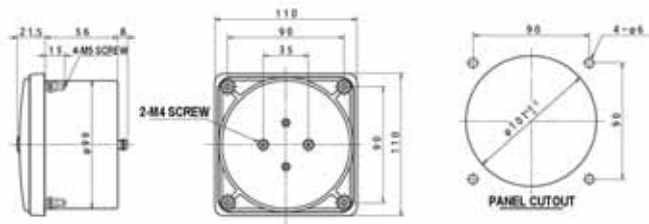

**L-80C**

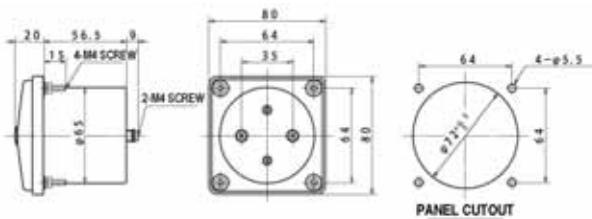

**L-65C**

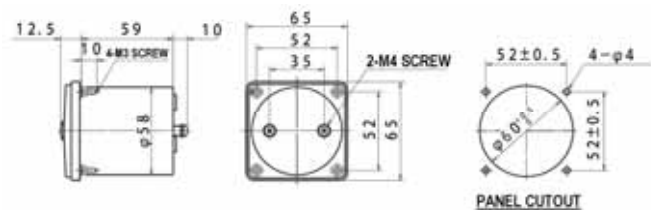

**§ Wide Angle *METER* § L Series**  
 AC AMMETER / VOLTMETER (MOVING IRON TYPE) **SL**

**2. VOLTMETER**

Max. Scale Value	Approx. VA Consumption		Attachment (Series Resistor)
	SL-110C	SL-80C, 65C	
50V 100V 150V 300V 600V	8VA	8VA	SL-80C,SL-65C: DM-41
600/150V ~ 550k/150V	8VA	8VA	

- ▶ For any max. scale value exceeding 600V, please use a 150V meter together with an external transformer for meter.
- ▶ Meter for SCR waveform input (distortion waveform) can be manufactured as well. (With H at the end of type name)  
 Type name: **SL-110CH**

**CONNECTION DIAGRAM**

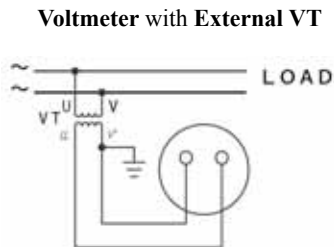
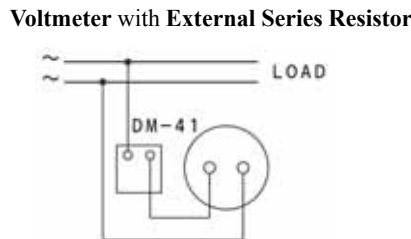
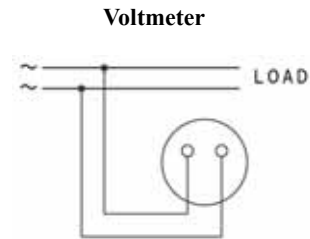

**DIMENSIONS**

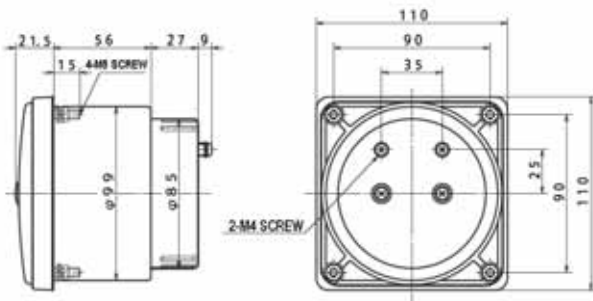

**DIMENSIONS (DM-41)**

